

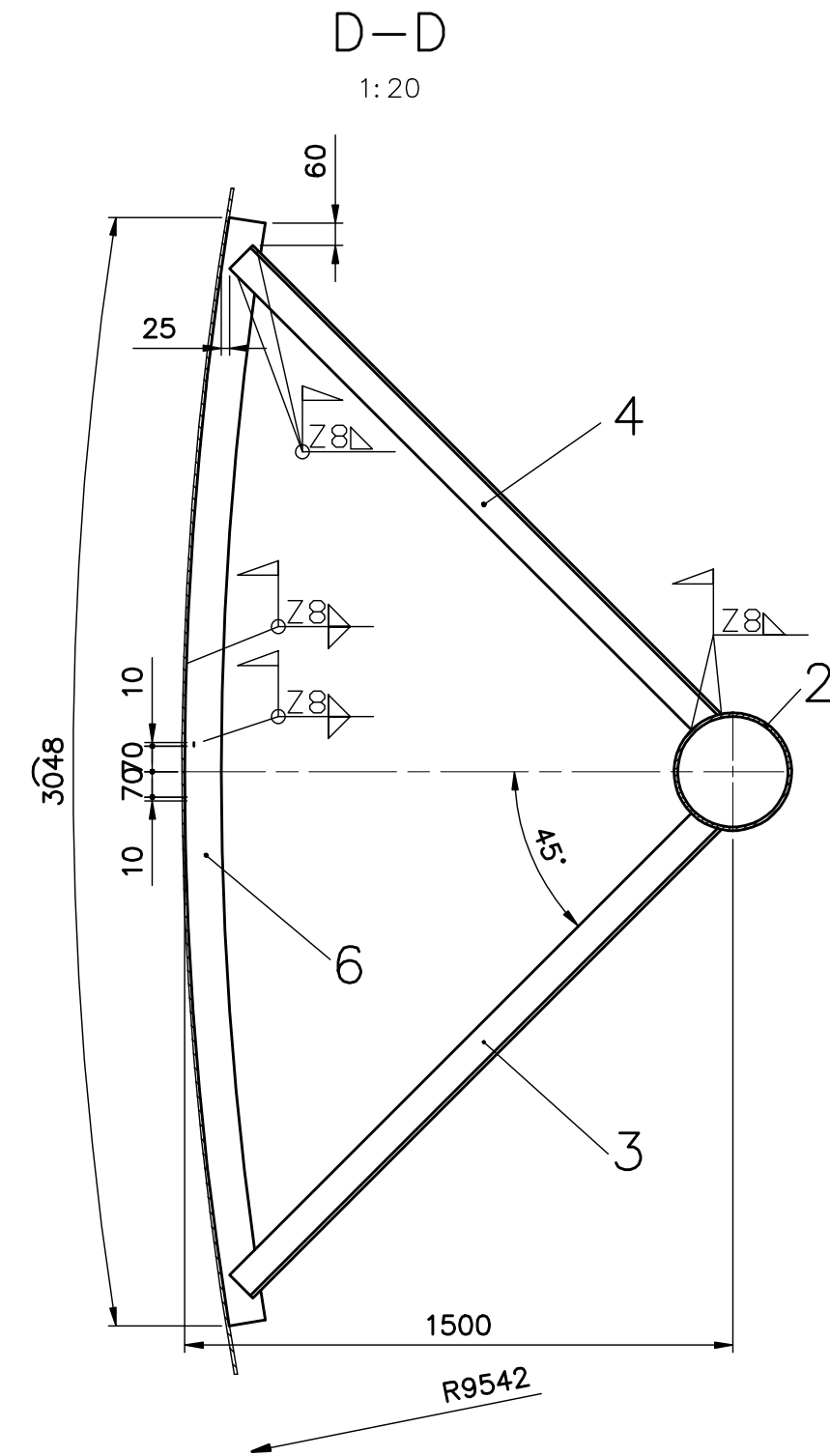

ACEST DOCUMENT ESTE PROPRIETATEA SOCIETATII ELLIS'92 S.R.L.-FLORESTI. IN CONSECINTA, FIRMA ARE DREPTUL EXCLUSIV DE FOLOSIRE A DESENULUI SAU DE OPERARE A EVENTUALELOR MODIFICARI DIN CAMPIUL ACESTUIA.

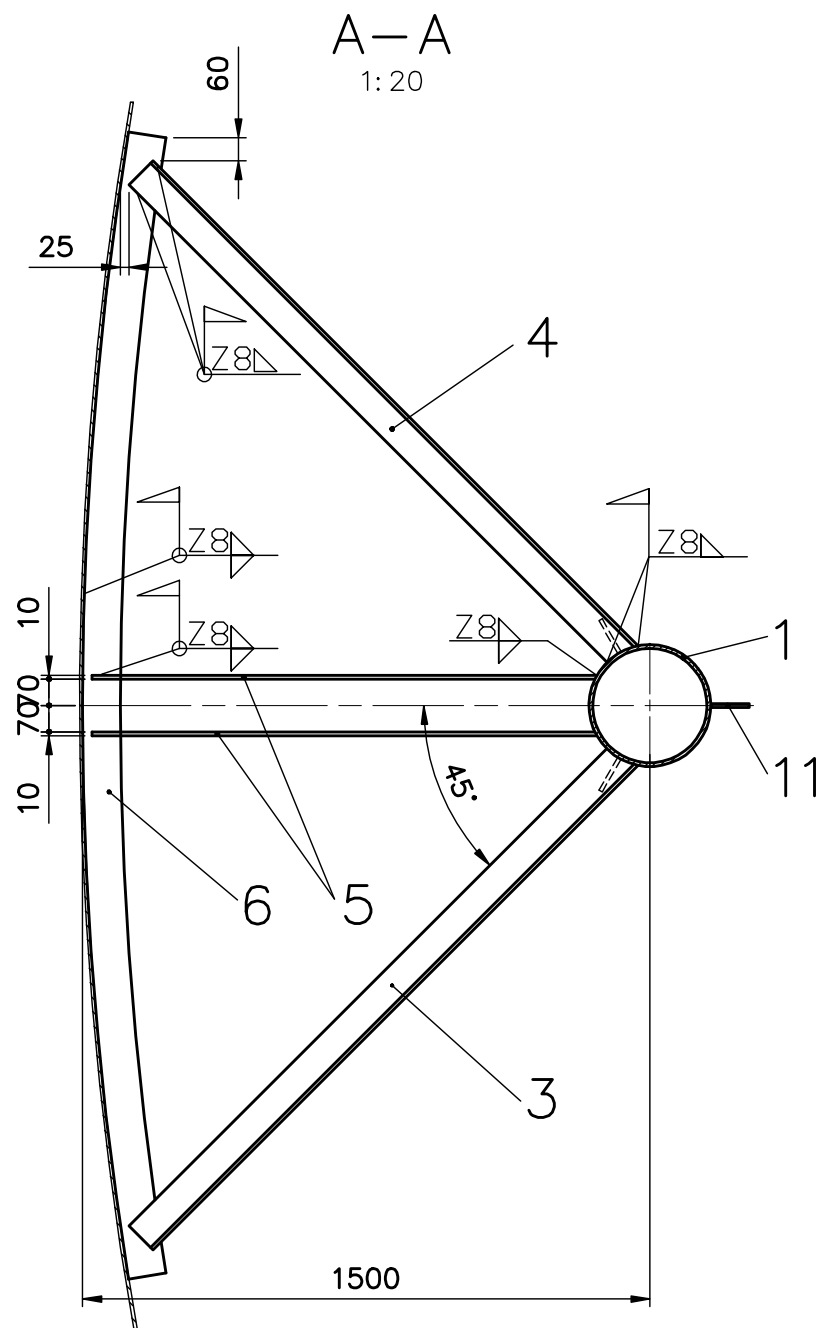
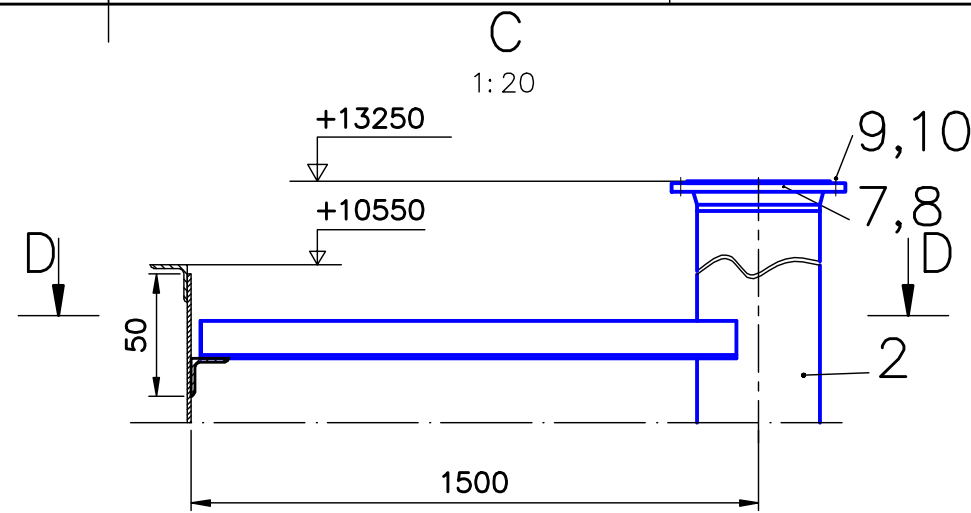
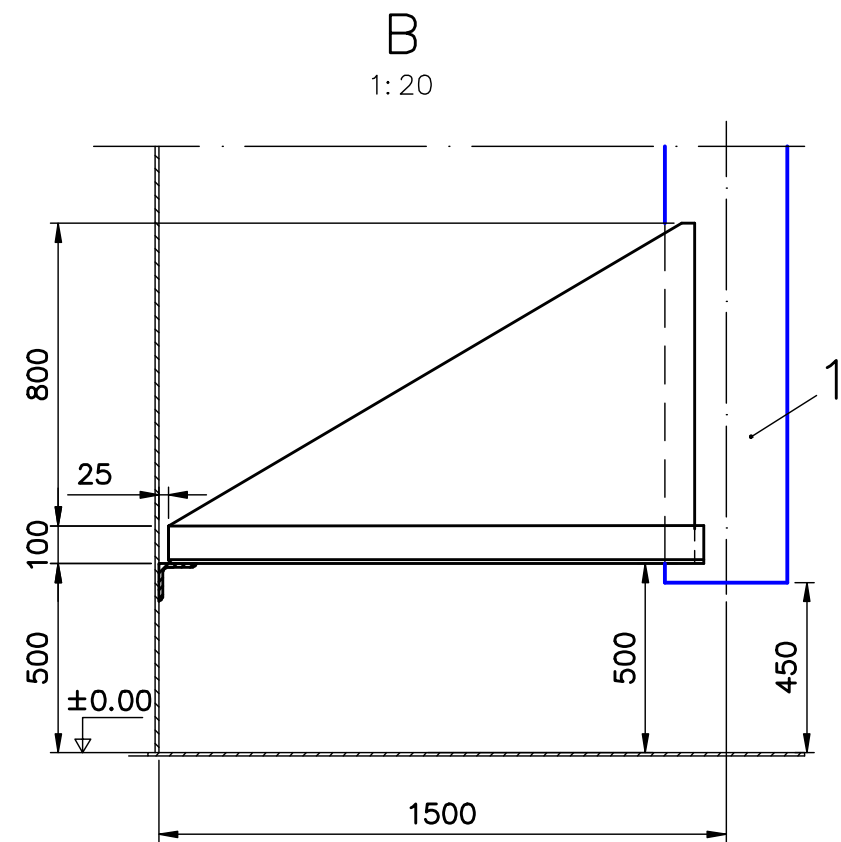
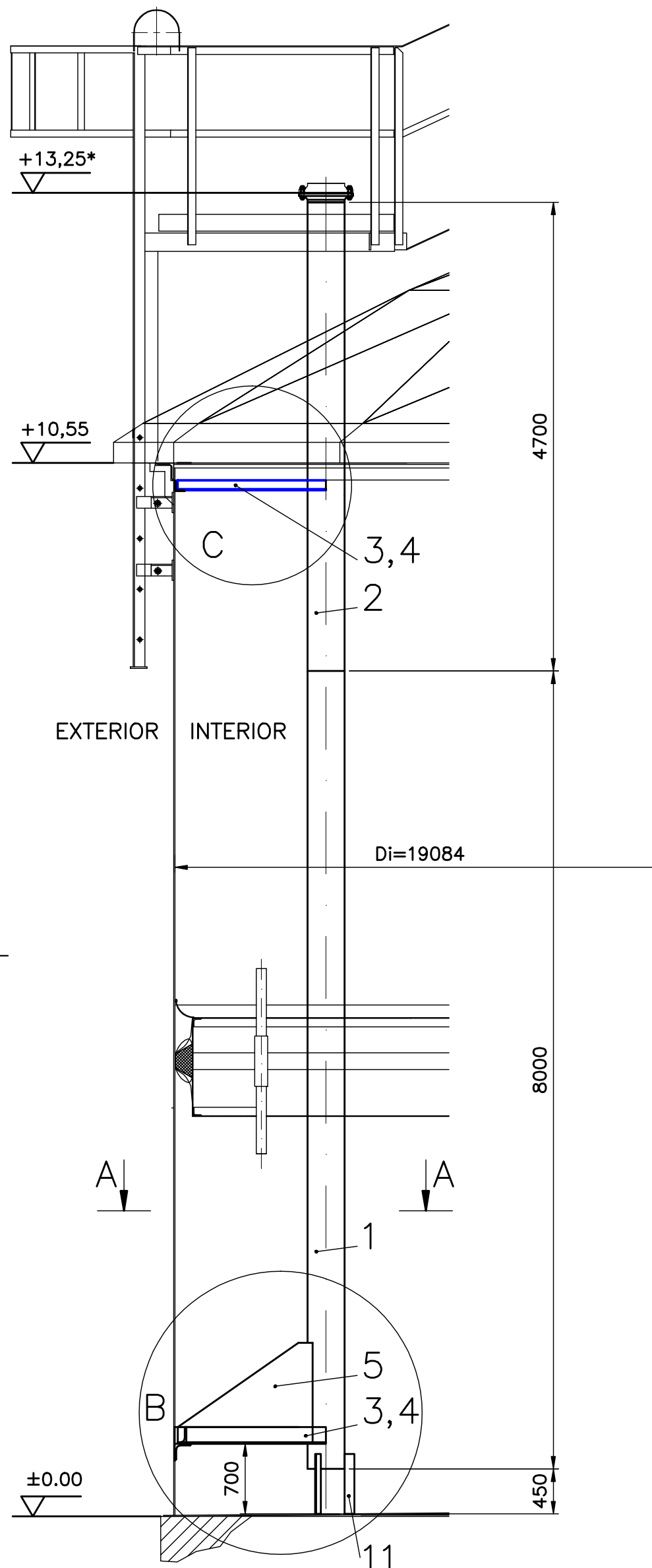

NOTA

1. Pentru pozitia racordului pe dom, vezi desen A614U-00
2. Cota notata cu (*) se definitiveaza dupa achizitionarea domului.

| | | | | | | | |
|---|---|---|-------------------------|------------------------------|---|------------------|--------------|
| 11 | Distanriere | | 3 | S235J2 SR EN 10025-2:2004 | Tb.100x600x10 | 4,71 | |
| 10 | Piulita stil 2 | | 24 | | | 0,0603 | |
| 9 | Prezon M20x140, tip1B | | 12 | | | 0,345 | |
| 8 | Garnitura | | 1 | | | 0.525 | |
| 7 | Flansa racordare DN300, tip 11, RF, PN16 | | 1 | P280GH SR EN 10222-2 | | 22.40 | |
| 6 | Cornier | | 2 | S235J2 SR EN 10025-2:2004 | L100x100x10-3048 | 45,72 | |
| 5 | Rigidizare | | 2 | S235J2 SR EN 10025-2:2004 | Tb.1340x800x8 | 40,10* | |
| 4 | Rigidizare | | 2 | S235J2 SR EN 10025-2:2004 | L80x80x8-1815 | 17,48 | |
| 3 | Rigidizare | | 2 | S235J2 SR EN 10025-2:2004 | L80x80x8-1815 | 17,48 | |
| 2 | Element stalp 2 | A586U-08.01 | 1 | | | 399 | |
| 1 | Element stalp 1 | A586U-08.01 | 1 | | | 680 | |
| | Electrozi | SR EN ISO 2560:2010 | - | | | 40 | |
| Poz. | Denumirea | Nr.desen sau STAS | Buc | Material | Observatii | Masa kg/buc | |
| 3 | | | 6 | | | | |
| 2 | | | 5 | | | | |
| 1 | | | 4 | | | | |
| Rev. | Descriere | Data | Semnat | Rev. | Descriere | Data | Semnat |
| Acest document este proprietatea S.C. ELLIS'92 S.R.L. si nu va fi comunicat fara autorizare | | | | | | | |
| Intocmit | Verificat | Aprobat | Beneficiar | | Denumire proiect | | |
| S.B. | N.R. | A.I. | CONPET S.A. | | DEZAFECTARE REZERVOR R9 TITEI (V=2.889 mc) CONSTRUCTIE REZERVOR NOU PENTRU TITEI (V=2.500 mc) STATIA DE POMPARE CARTOJANI | | |
|  | |  | TEAVA PENTRU RADAR SAAB | | | Nr.: A614U-08.00 | Rev.0 |
| | | | | | | Scara:1:100 | |
| | | | | | | Index:A614U-BD | Rev.0 |
| | | | Material: | | | Masa:1403 kg | Data:04.2017 |
| A2 (420x594) | | | | | | | |